



KINVARO FLAP SYSTEMS

Comfort in four dimensions.
Kinvaro offers perfect movement solutions
for every application.

QUALITY CERTIFICATE
LGA



KINVARO F-20
FOLDING FLAP SYSTEM



KINVARO L-80
PARALLEL LIFT FLAP
SYSTEM



KINVARO S-35
UP-AND-OVER
FLAP SYSTEM



KINVARO T-SERIES
LIFT-UP FLAP SYSTEMS

CABINET & FURNITURE MECHANISMS – GRASS

GRASS KINVARO FLAP SYSTEMS



KINVARO F-20 FOLDING FLAP FITTING

- For wall cabinets with split fronts
- Comfortable opening and closing of heavy flaps with spring support
- Integrated adjustable closing damper
- Opening limiter adjustable to 90°
- Wide range of applications for many different flap materials
- Weight 3.8 to 19.2 kg
- Pre-assembled Euro screws for fixing the fitting to the side wall
- Range of flaps: width: 400 – 1200 mm, height: 520 – 900 mm

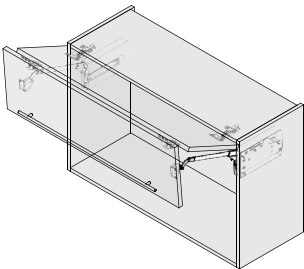

NOTES

APPLICATION RANGE		FLAP WEIGHT INCL. HANDLE (KG)		
CABINET HEIGHT	GUIDE LEVER	SPRING B	SPRING C	SPRING D
520 – 559	Type 2	4.6 – 13.8		
560 – 599	Type 3	4.4 – 12.6	7.0 – 14.7	
600 – 649	Type 4	4.1 – 12.1	6.8 – 15.8	
650 – 699	Type 5	3.8 – 11.4	6.7 – 16.9	
700 – 749	Type 6		6.5 – 16.4	10.0 – 18.0
750 – 900	Type 7		6.0 – 15.6	8.6 – 19.2

ORDER INFORMATION –

KINVARO F-20 SET

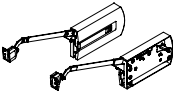

CABINET HEIGHT	GUIDE LEVER	SPRING B	SPRING C	SPRING D
520 – 559	Type 2	128201		
560 – 599	Type 3	128202		
600 – 649	Type 4	128203		
650 – 699	Type 5	128204		
700 – 749	Type 6		128205	
750 – 900	Type 7			128206

Note:
Please order separately: Tiomos 120° hinges (017123) with spring, without damper, and Tiomos mounting plates for top panel.

Kinvaro F-20 set comprises:

- 1** Fitting, right and left (1x)
 - 2** Screw-on bracket for wood, incl. cover caps (2x)
 - 3** Cover caps, right and left, in WHITE (1x)
 - 4** Connecting hinges (2x)
- Paper template (1x)
Installation instructions (1x)

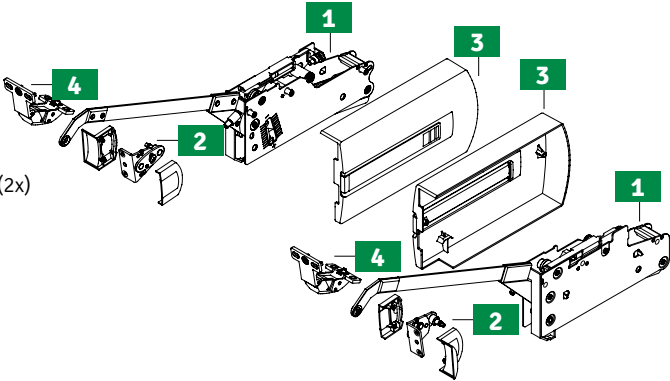



ASSEMBLY AND INSTALLATION INSTRUCTIONS

ALL DIMENSIONS IN MILLIMETRES

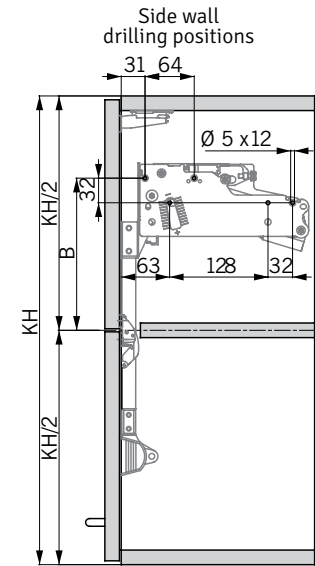
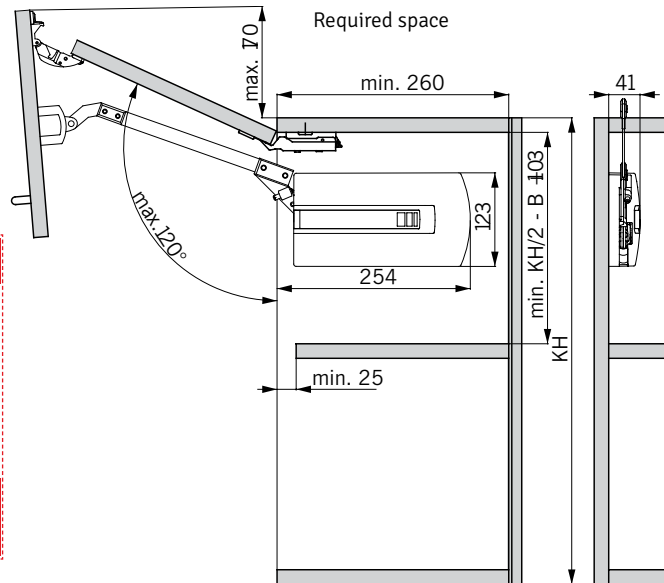
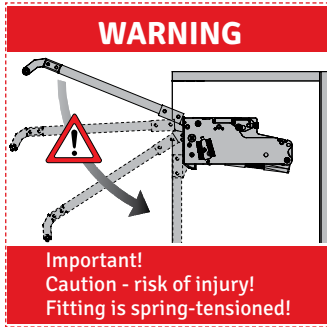

Side wall drilling distance			
KH	Type	B	
520 – 529	2	173	
530 – 539	2	158	
540 – 549	2	143	
550 – 559	2	128	
560 – 569	3	183	
570 – 579	3	168	
580 – 589	3	153	
590 – 599	3	138	
600 – 609	4	208	
610 – 619	4	198	
620 – 629	4	178	
630 – 639	4	168	
640 – 649	4	158	
650 – 699	5	225	
700 – 749	6	235	
750 – 800	7	250	

Front:
installation for flaps with standard aluminium frame profiles (19 mm)

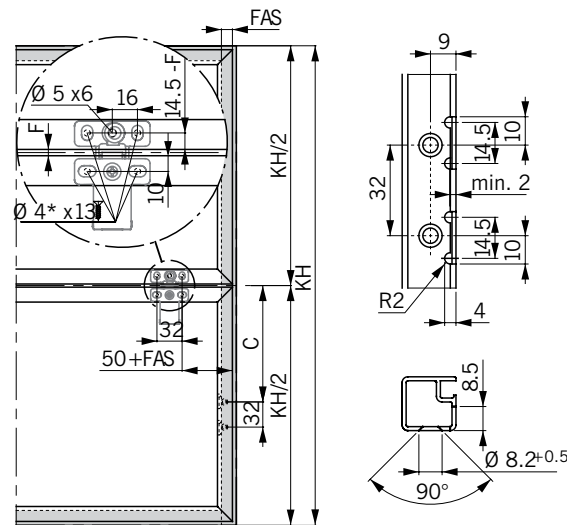

* Pre-drilling required - Ø 2 mm

Front: installation for wooden and frame flaps (min. 45 mm width)

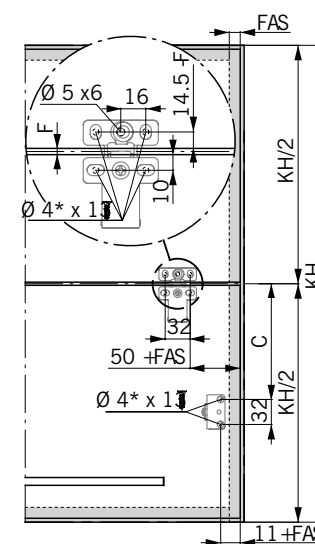

* Pre-drilling required - Ø 2 mm

Front: drilling distance			
KH	Type	C	
520 – 529	2	133	
530 – 539	2	148	
540 – 549	2	163	
550 – 559	2	178	
560 – 569	3	145	
570 – 579	3	160	
580 – 589	3	175	
590 – 599	3	190	
600 – 609	4	138	
610 – 619	4	148	
620 – 629	4	168	
630 – 639	4	178	
640 – 649	4	188	
650 – 699	5	146	
700 – 749	6	156	
750 – 800	7	166	

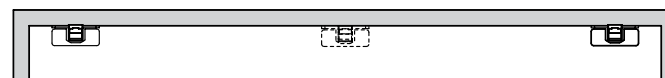

Number of hinges at top panel

From 900 mm cabinet width: 3 hinges. Hinges with spring require an opening angle of min. 120°

Calculation of flap weight

Flap width x flap height x flap thickness x density¹ + weight of handle² = weight of flap

¹ Densities: MDF 0.85 kg/dm³, chipboard 0.65 kg/dm³, spruce/pine 0.45 kg/dm³

² For bar handles, allow 0.1 kg for each 100 mm handle width. We recommend a trial fitting

LEGEND					
B	Drilling dimension – side wall	F	Reveal	KH	Cabinet height
C	Drilling dimension – front	FAS	Front overlay, side		

CABINET & FURNITURE MECHANISMS – GRASS

GRASS KINVARO FLAP SYSTEMS



KINVARO L-80 PARALLEL FLAP FITTING

- Extremely smooth movement
- Also suitable for handle-free fronts
- Holds flap securely in any position
- Wide range of applications for various flap materials and weights, e.g. wood, glass, MDF with narrow or wide aluminium or wooden frames
- Easy to fit
- Extremely strong
- Integrated adjustable closing damper
- Range of flaps: width: 450 – 1200 mm, height: 350 – 600 mm

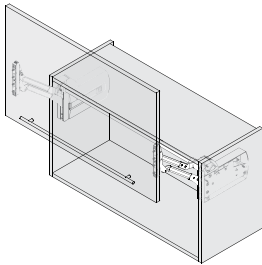

NOTES

APPLICATION RANGE		FLAP WEIGHT INCL. HANDLE (KG)		
CABINET HEIGHT	GUIDE LEVER	SPRING B	SPRING C	SPRING D
350 – 369	Type 1	2.5 – 6.5	6.0 – 9.5	8.5 – 9.6
370 – 389	Type 2	2.3 – 6.0	5.5 – 9.0	
390 – 409	Type 3	2.1 – 5.5	5.0 – 8.5	8.0 – 10.1
410 – 429	Type 4	1.9 – 5.0	4.5 – 8.0	7.5 – 14.6
430 – 600	Type 5	2.0 – 4.5	4.0 – 7.5	7.0 – 14.6

ORDER INFORMATION –

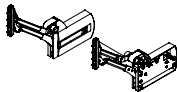

KINVARO L-80 SET

CABINET HEIGHT	GUIDE LEVER	SPRING B	SPRING C	SPRING D
350 – 369	Type 1	128801	128802	
370 – 389	Type 2			
390 – 409	Type 3		128803	
410 – 429	Type 4		128804	
430 – 600	Type 5			128805

Kinvaro L-80 set comprises:

- 1 Fitting, right and left (1x)
- 2 Cover caps, right and left, in WHITE (1x)
- 3 1090mm cross bar for cutting to length (1x)
- 4 Sliding sleeves (2x)
- 5 Mounting plates (2x)
- Paper template (1x)
- Installation instruction

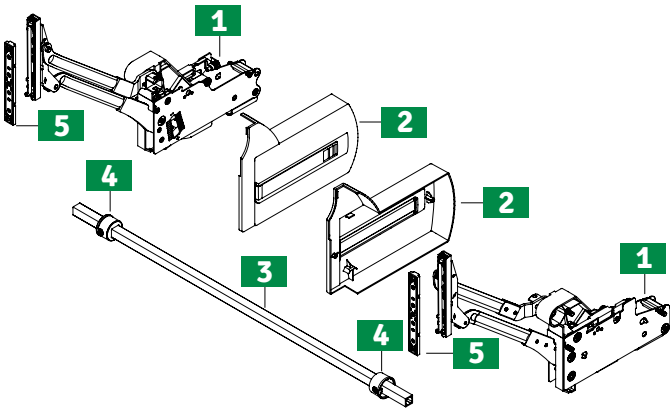

GRASS KINVARO FLAP SYSTEMS



ASSEMBLY AND INSTALLATION INSTRUCTIONS

ALL DIMENSIONS IN MILLIMETRES

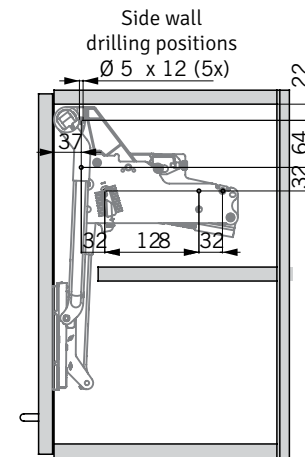
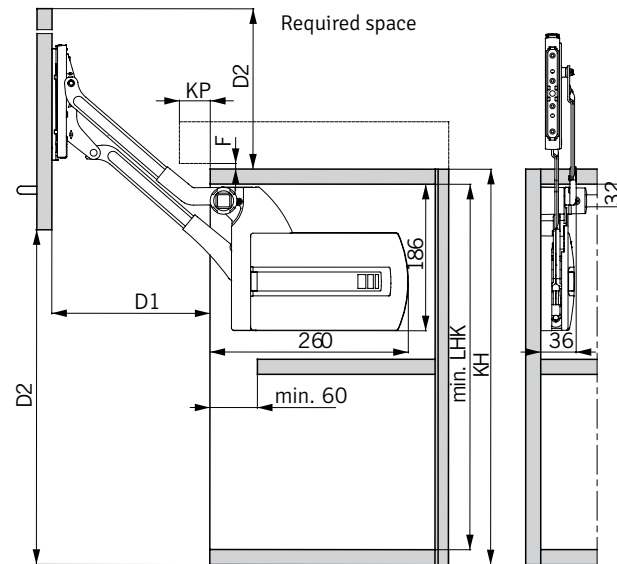
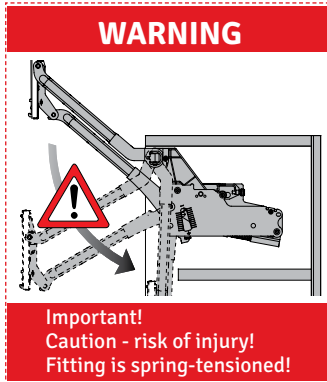

Type	min. LHK	D1	D2
1	312	161	304
2	332	176	337
3	352	191	370
4	372	206	403
5	392	221	436

Cornice projection	
F	KP max.
2	22
3	35
4	39

Front:
installation for flaps with standard aluminium frame profiles (19 mm)

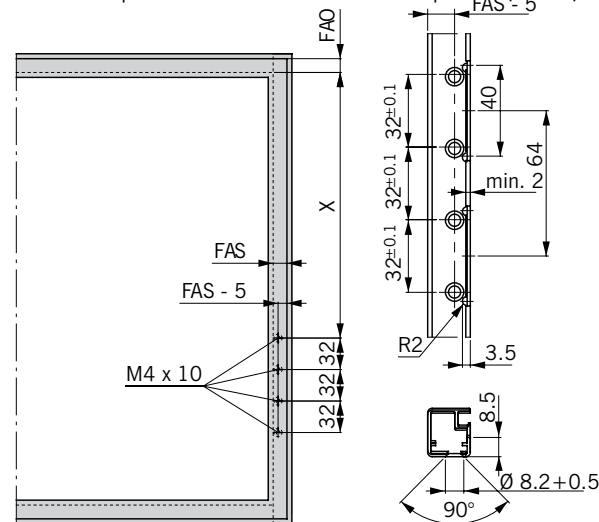

Front: installation for wooden and frame
flaps (min. 45 mm width) ♀

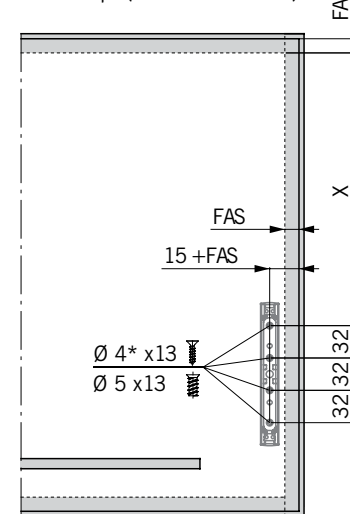

Front: drilling distance		
KH	Type	C
350 – 369	1	190
370 – 389	2	210
390 – 409	3	230
410 – 429	4	250
430 – 600	5	270

Cross bar dimensions

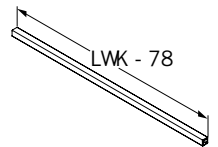

* Pre-drilling required - Ø 2 mm

Calculation of flap weight

$$\text{Flap width} \times \text{flap height} \times \text{flap thickness} \times \text{density}^1 + \text{weight of handle}^2 = \text{weight of flap}$$
¹ Densities: MDF 0.85 kg/dm³, chipboard 0.65 kg/dm³, spruce/pine 0.45 kg/dm³

² For bar handles, allow 0.1 kg for each 100 mm handle width. We recommend a trial fitting

LEGEND					
D	Distance	FAO	Fron overlay, top	KH	Cabinet height
F	Reveal	FAS	Front overlay, side	KP	Cornice
LHK	Inside cabinet height				

CABINET & FURNITURE MECHANISMS – GRASS

GRASS KINVARO FLAP SYSTEMS



KINVARO S-35 UP-AND-OVER FLAP FITTING

- Allows the use of cornices, pelmets and attached lights
- Suitable for handle-free fronts
- Integrated adjustable damping system enables quiet, gentle closing
- Flap 3-dimensionally adjustable - height, side, angle: direct adjustment ±1.5 mm
- Fast, tool-free installation
- Securely holds flap in any position from 45° opening angle
- Range of flaps:
width: 450 – 1200 mm
height: 420 – 750 mm

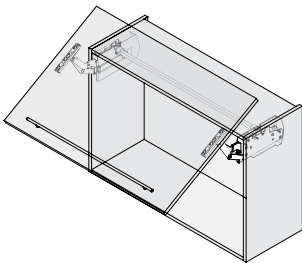

NOTES

APPLICATION RANGE	FLAP WEIGHT INCL. HANDLE (KG)				
FLAP HEIGHT	SPRING A	SPRING B	SPRING C	SPRING D	SPRING E
420 – 449	1.5 – 7.5	5.0 – 11.0			
450 – 479	1.8 – 7.5	5.0 – 12.0			
480 – 509	1.8 – 6.5	5.0 – 12.5			
510 – 539	2.0 – 6.0	5.0 – 13.0			
540 – 569	2.0 – 6.0	5.0 – 12.5	6.0 – 14.0		
570 – 599	2.0 – 6.0	5.0 – 11.0	5.5 – 12.0	11.5 – 14.5	
600 – 629	2.0 – 5.5	4.5 – 10.0	5.5 – 11.5	10.5 – 15.5	
630 – 659	2.0 – 5.5		4.5 – 11.0	8.5 – 16.0	
660 – 689	2.0 – 5.0		4.0 – 10.0	7.5 – 15.0	12.0 – 16.5
690 – 719	2.0 – 5.0		4.0 – 8.5	6.5 – 13.5	12.0 – 17.5
720 – 750			4.0 – 8.0	6.5 – 12.5	10.0 – 17.0

ORDER INFORMATION –

KINVARO S-35 SET

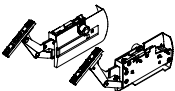

FLAP HEIGHT	SPRING A	SPRING B	SPRING C	SPRING D	SPRING E
420 - 750	128351	128352	128353	128354	

Kinvaro S-35 set comprises:

- 1 Fitting, right and left (1x)
- 2 Cover caps, right and left, in WHITE (1x)
- 3 1090 mm cross bar for cutting to length (1x)
- 4 Sliding sleeves (2x)
- 5 Mounting plates (2x)
- Paper template (1x)
- Installation instruction

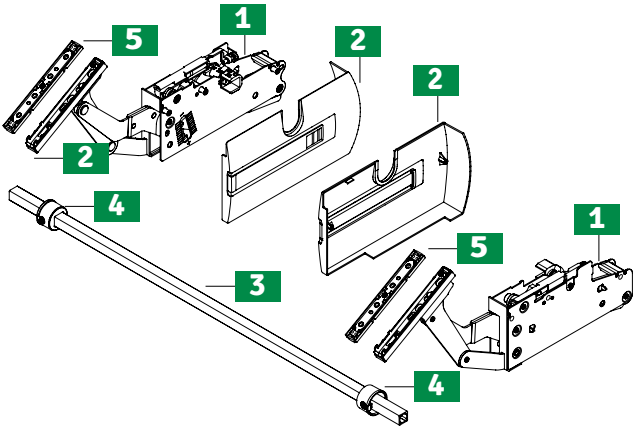



ASSEMBLY AND INSTALLATION INSTRUCTIONS

ALL DIMENSIONS IN MILLIMETRES

WARNING

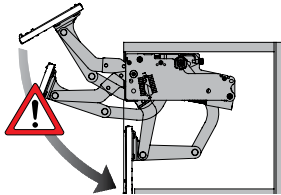

Important!
Caution - risk of injury!
Fitting is spring-tensioned!

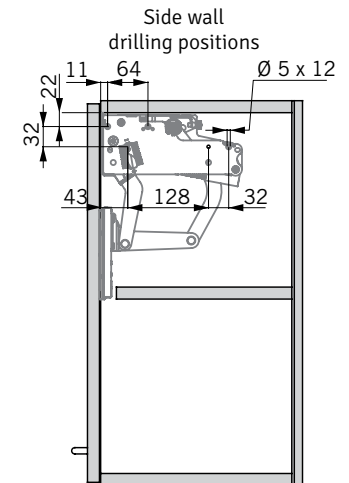
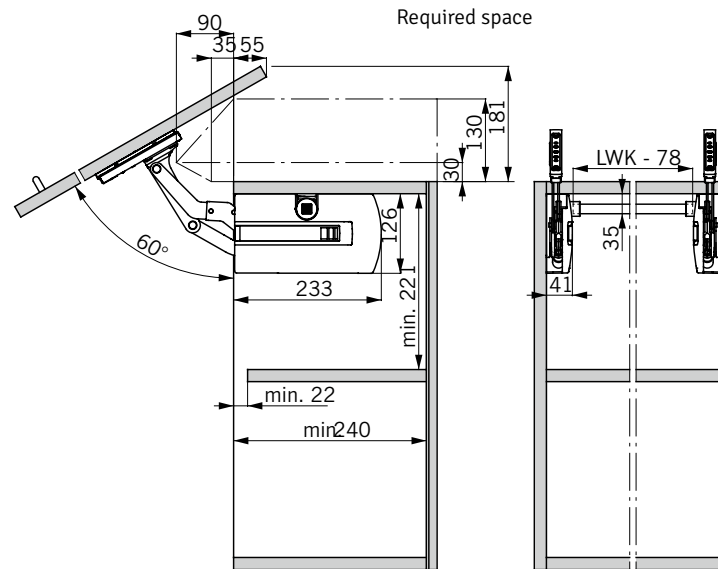

Front:
installation for flaps with standard aluminium frame profiles (19 mm)

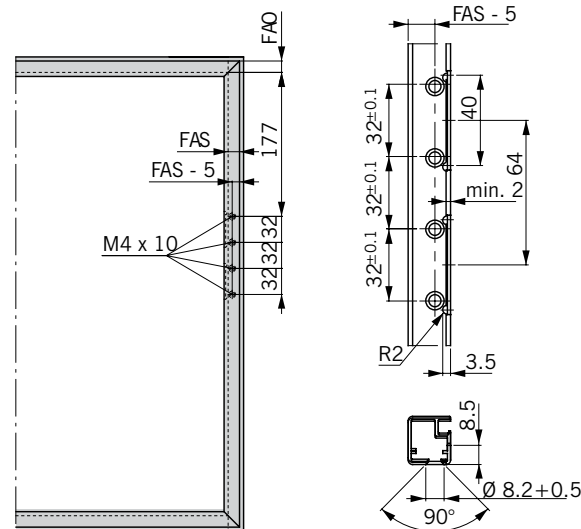

Front: installation for wooden and frame flaps
(min. 45 mm width)

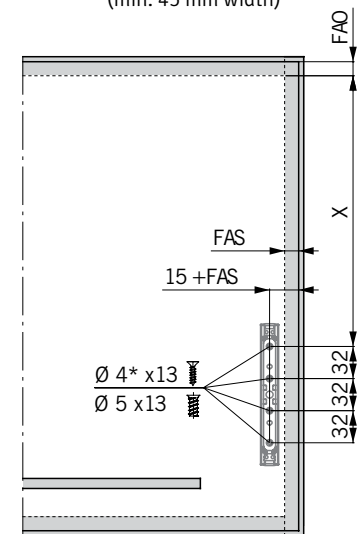

* Pre-drilling required - Ø 2 mm

Calculation of flap weight

Flap width x flap height x flap thickness x density ¹ + weight of handle ² = weight of flap

¹ Densities: MDF 0.85 kg/dm³, chipboard 0.65 kg/dm³, spruce/pine 0.45 kg/dm³

² For bar handles, allow 0.1 kg for each 100 mm handle width. We recommend a trial fitting

LEGEND

FAO	Front overlay, top	FAS	Front overlay, side	LWK	Inside cabinet width
-----	--------------------	-----	---------------------	-----	----------------------

CABINET & FURNITURE MECHANISMS – GRASS

GRASS KINVARO FLAP SYSTEMS



KINVARO T-71 LIFT-UP FLAP FITTING

- Tool-free clip-on installation of front
- Direct, 3-dimensional adjustment of front
- Integrated adjustable damping system enables quiet, gentle closing
- Extremely comfortable opening thanks to spring-supported opening mechanism
- No hinges fitted to the top panel
- Variable opening angle - holds flap securely at any angle between 45° and 110°
- Allows additional cabinet installation above
- Range of flaps:
width: up to 1200 mm
height: 300 – 600 mm

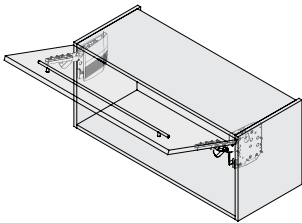

G*GRASS®

NOTES

APPLICATION RANGE	FLAP WEIGHT INCL. HANDLE (KG)	
FLAP HEIGHT	SPRIN, WHITE	SPRING, ORANGE
300	2.1 – 7.4	2.5 – 8.5
350	1.8 – 6.3	2.3 – 7.5
400	1.7 – 5.4	2.1 – 6.8
450	1.6 – 4.7	2.0 – 5.8
500	1.5 – 4.0	1.8 – 5.0
550	1.4 – 3.7	1.6 – 4.6
600	1.4 – 3.3	1.4 – 4.2

ORDER INFORMATION –

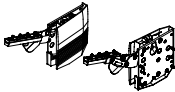

KINVARO T-71 SET

DESIGNATION	SPRINGS	VERSION FOR	OVERLAY	CODE
Kinvaro T-71 right without and left with damper, pre-assembled springs, white, incl. cover caps, WHITE, 2 springs, orange, loose	white/orange	wood	variable	128711

Kinvaro T-71 set comprises:

- 1 Fitting on the right without and on the left with damper (1x)
- 2 Cover caps, right and left, in WHITE (1x)
- 3 Mounting plates (2x)
Springs, orange, loose (2x)
Paper template (1x)
Installation instructions (1x)

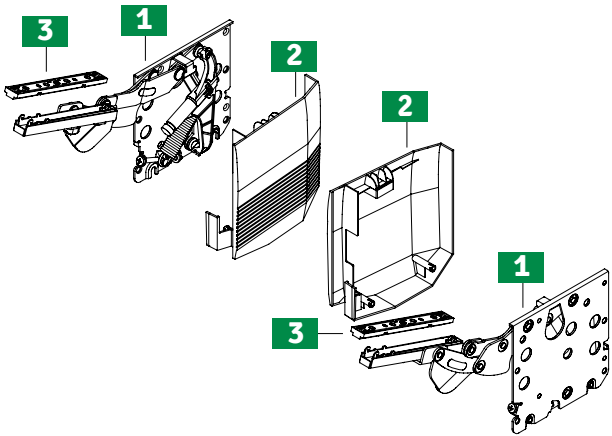



ASSEMBLY AND INSTALLATION INSTRUCTIONS

ALL DIMENSIONS IN MILLIMETRES

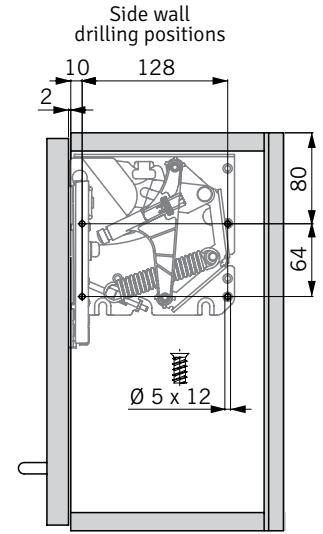
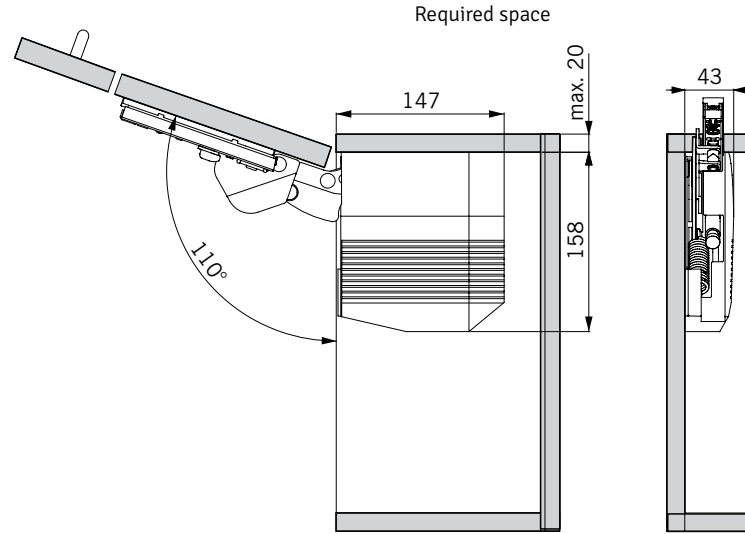
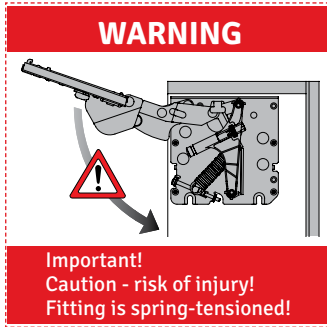

Front:
installation for flaps with standard aluminium frame profiles (19 mm)

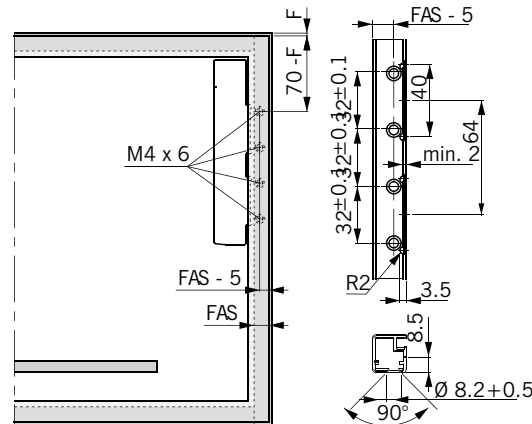

* Standard aluminium frame profile (19 mm)

Front: installation for wooden and frame flaps
(min. 55 mm width)

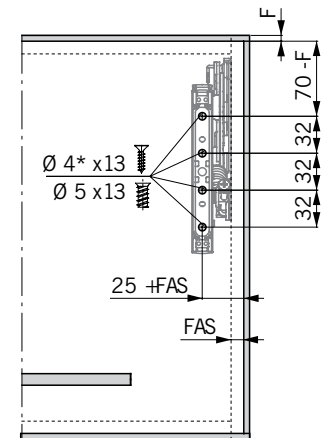

* Pre-drilling required - Ø 2 mm

Calculation of flap weight

Flap width x flap height x flap thickness x density¹ + weight of handle² = weight of flap

¹ Densities: MDF 0.85 kg/dm³, chipboard 0.65 kg/dm³, spruce/pine 0.45 kg/dm³

² For bar handles, allow 0.1 kg for each 100 mm handle width. We recommend a trial fitting

LEGEND

F	Reveal	FAS	Front overlay, side		
---	--------	-----	---------------------	--	--



KINVARO T-76 LIFT-UP FLAP FITTING

- Tool-free clip-on installation of front
- Direct, 3-dimensional adjustment of front
- Integrated adjustable damping system enables quiet, gentle closing
- Extremely comfortable opening thanks to spring-supported opening mechanism
- No hinges fitted to the top panel
- Variable opening angle - holds flap securely at any angle between 45° and 110°
- Allows additional cabinet installation above
- Range of flaps:
width: up to 1200 mm
height: 300 – 600 mm

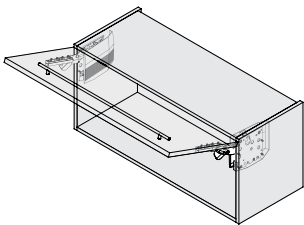

NOTES

APPLICATION RANGE	FLAP WEIGHT INCL. HANDLE (KG)
FLAP HEIGHT	SPRING STANDARD
400	7.0 – 11.0
450	6.7 – 9.6
500	5.8 – 8.5
550	5.6 – 7.6
600	5.2 – 7.0

ORDER INFORMATION –

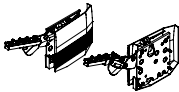

KINVARO T-76 SET

DESIGNATION	SPRINGS	VERSION FOR	OVERLAY	CODE
Kinvaro T-76 on the right without and on the left with damper, pre-assembled springs, standard, incl. cover caps, WHITE	standard	wood	variable	128762

Kinvaro T-76 set comprises:

- 1 Fitting on the right without and on the left with damper (1x)
- 2 Cover caps, right and left, in WHITE (1x)
- 3 Mounting plates (2x)
Paper template (1x)
Installation instructions (1x)

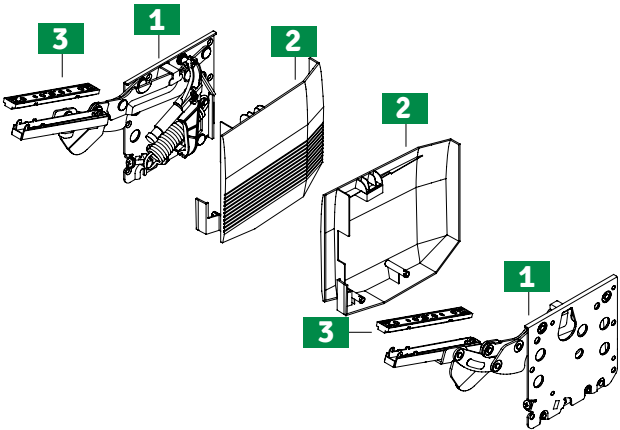



ASSEMBLY AND INSTALLATION INSTRUCTIONS

ALL DIMENSIONS IN MILLIMETRES

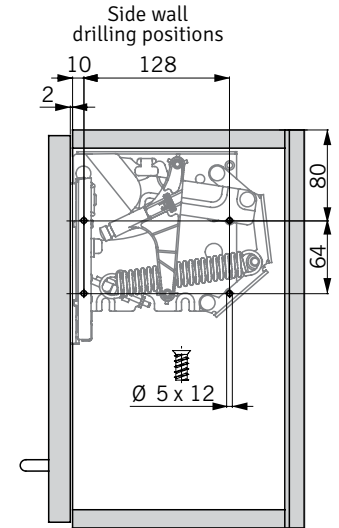
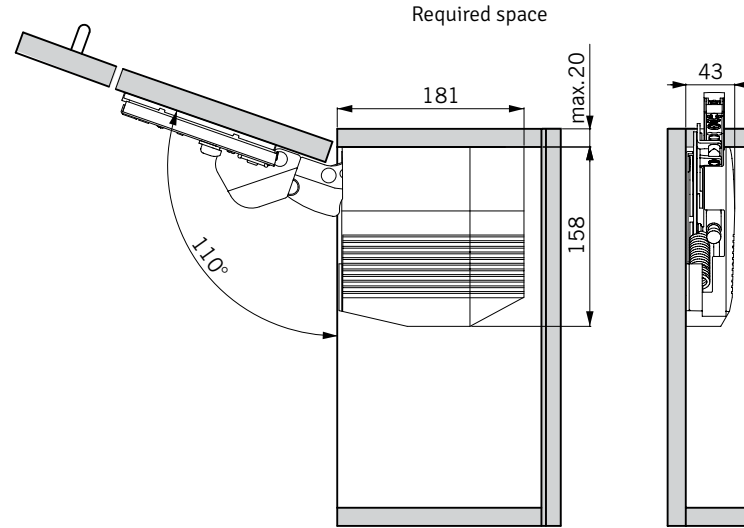
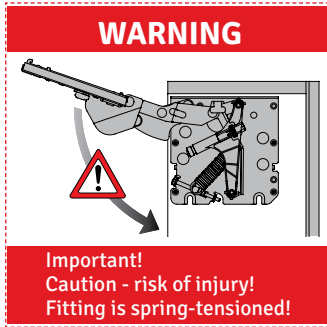

Front:
installation for flaps with standard aluminium frame profiles (19 mm)

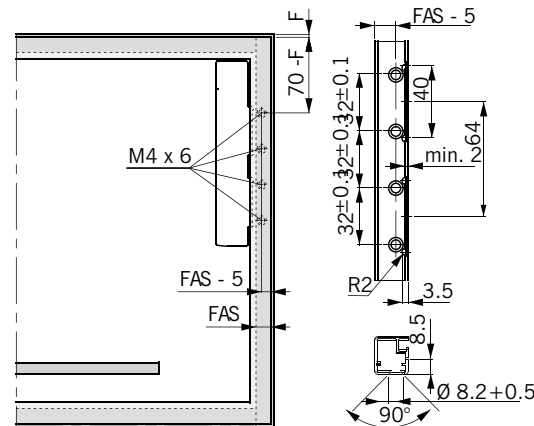

Front: installation for wooden and frame flaps
(min. 55 mm width)

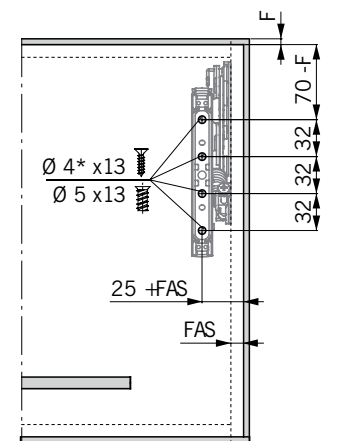

* Pre-drilling required - Ø 2 mm

Calculation of flap weight

Flap width x flap height x flap thickness x density ¹ + weight of handle ² = weight of flap

¹ Densities: MDF 0.85 kg/dm³, chipboard 0.65 kg/dm³, spruce/pine 0.45 kg/dm³

² For bar handles, allow 0.1 kg for each 100 mm handle width. We recommend a trial fitting

LEGEND

F	Reveal	FAS	Front overlay, side		
---	--------	-----	---------------------	--	--

CABINET & FURNITURE MECHANISMS – GRASS

GRASS KINVARO FLAP SYSTEMS



KINVARO T-57 LIFT-UP FLAP FITTING

- Suitable for medium-sized flaps
- Opening angle adjustable to 75° or 90°
- For wooden and aluminium frame flaps
- Easy to fit
- Allows additional cabinet installation above
- High-quality finish, nickel-plated
- Height of flap can be adjusted via slots
- Range of flaps:
width: up to 1200 mm
height: 300 – 600 mm

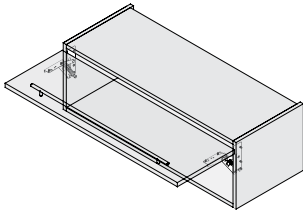

G*GRASS®

NOTES

APPLICATION RANGE	FLAP WEIGHT INCL. HANDLE (KG)	
FLAP HEIGHT (FRONT THICKNESS 19MM)	MIN.	MAX.
300	1.0	6.2
350	1.2	4.9
400	1.4	3.8
450	1.5	3.6
500	1.7	2.9
550	1.9	2.7
600	2.1	2.5

ORDER INFORMATION –

KINVARO T-57 SET

DESIGNATION	SIDE	VERSION FOR	OVERLAY	CODE
Kinvaro T-57 nickel-plated adjustable springs right and left	1 set	wood	variable	128571
	left	wood	variable	012748
Kinvaro T-57 white	right	wood	variable	012749

Kinvaro T-57 set comprises:

- 1
- Fitting, right and left (1x)
Paper template (1x)
Installation instructions (1x)

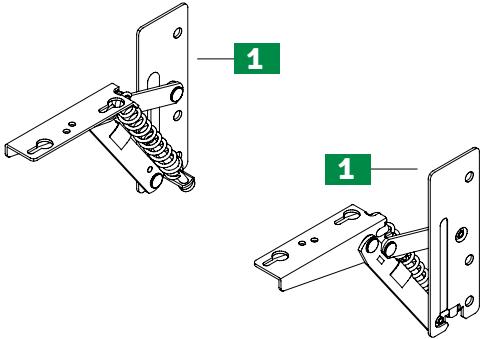



ASSEMBLY AND INSTALLATION INSTRUCTIONS

ALL DIMENSIONS IN MILLIMETRES

Required space

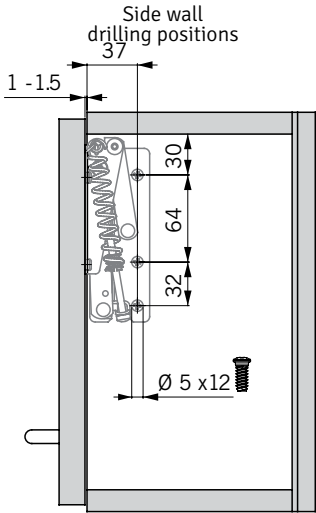
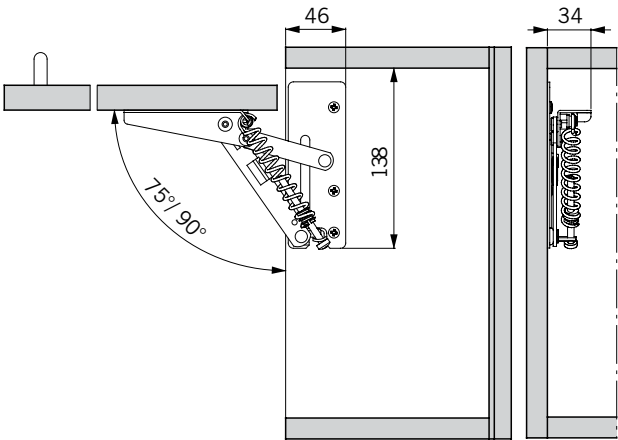

Front:
installation for flaps with standard aluminium frame profiles (19 mm)

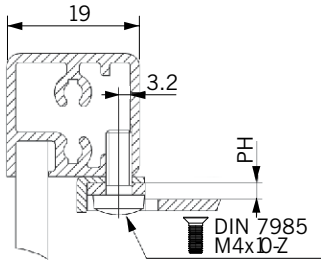
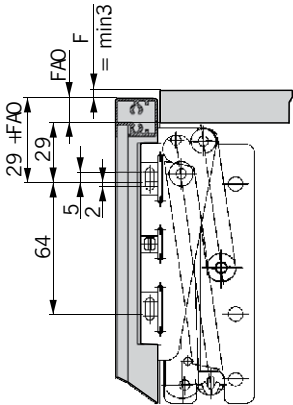

Front: installation for wooden and frame flaps
(min. 55 mm width)

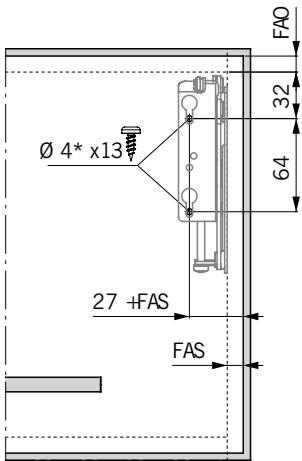

* Pre-drilling required - Ø 2 mm

Calculation of flap weight

Flap width x flap height x flap thickness x density ¹ + weight of handle ² = weight of flap

¹ Densities: MDF 0.85 kg/dm³, chipboard 0.65 kg/dm³, spruce/pine 0.45 kg/dm³

² For bar handles, allow 0.1 kg for each 100 mm handle width. We recommend a trial fitting

LEGEND					
F	Reveal	FAO	Front overlay, top	FAS	Front overlay, side
PH	Stamping height				

CABINET & FURNITURE MECHANISMS – GRASS

GRASS KINVARO FLAP SYSTEMS



- KINVARO T-105 FLAP STAY**
- Variable opening angle, holds flaps securely from 45° to 105°
 - Spring-supported opening function
 - Convenient access, flap lifts clear of the work area
 - Suitable for wooden doors and aluminium frames with glass infill
 - Allows additional cabinet installation above
 - Maintenance-free, no readjustment required
 - High-quality zinc diecasting, nickel-plated
 - Range of flaps: width: up to 1200 mm, height: 300 – 500 mm

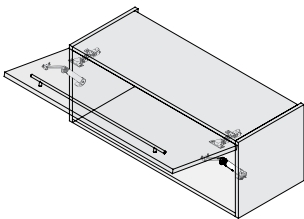

Note: Tiomos 120° hinges with spring, without damper, and Tiomos mounting plates for top panel need to be ordered separately.

APPLICATION RANGE	FLAP HEIGHT	NUMBER OF FLAP STAY	FLAP WEIGHT INCL. HANDLE (KG)	
			SPRING, STANDARD	SPRING, BLACK
300		1	1.6 – 4.3	2.8 – 5.2
		2	3.2 – 8.6	5.5 – 10.4
350		1	1.3 – 4.1	2.4 – 4.8
		2	2.6 – 8.1	4.8 – 9.5
400		1	1.3 – 3.4	2.2 – 4.0
		2	2.6 – 6.8	4.3 – 8.1
450		1	1.2 – 3.0	1.9 – 3.8
		2	2.4 – 6.1	3.8 – 7.4
500		1	1.1 – 2.9	1.7 – 3.5
		2	2.2 – 5.8	3.3 – 6.7

ORDER INFORMATION –

KINVARO T-105 SET

DESIGNATION	SPRINGS	VERSION FOR	OVERLAY	LEFT CODE	RIGHT CODE
Kinvaro T-105 right, adjustable standard springs, incl. black cover cap	standard	wood	variable	012741	012742

Kinvaro T-105 set comprises:

- 1 Fitting, right and left (1x)
- 2 Cover caps, right or left, in black (1x)
- Paper template (1x)
- Installation instructions (1x)

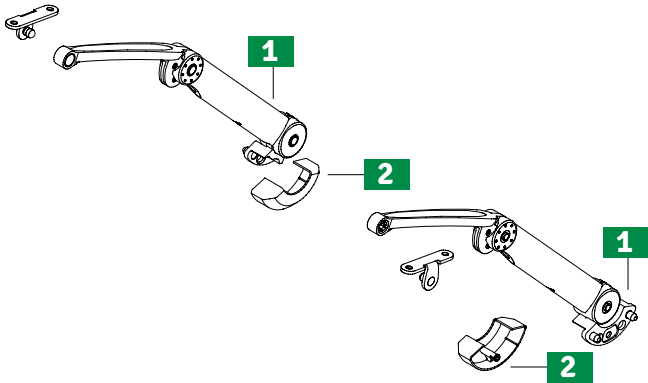

G*GRASS®

NOTES



ASSEMBLY AND INSTALLATION INSTRUCTIONS

ALL DIMENSIONS IN MILLIMETRES

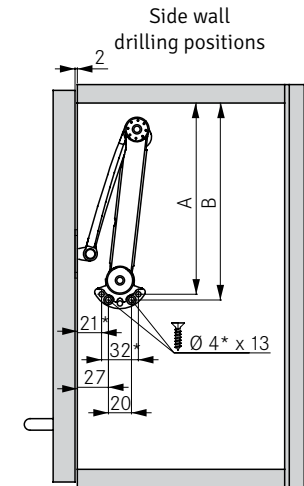
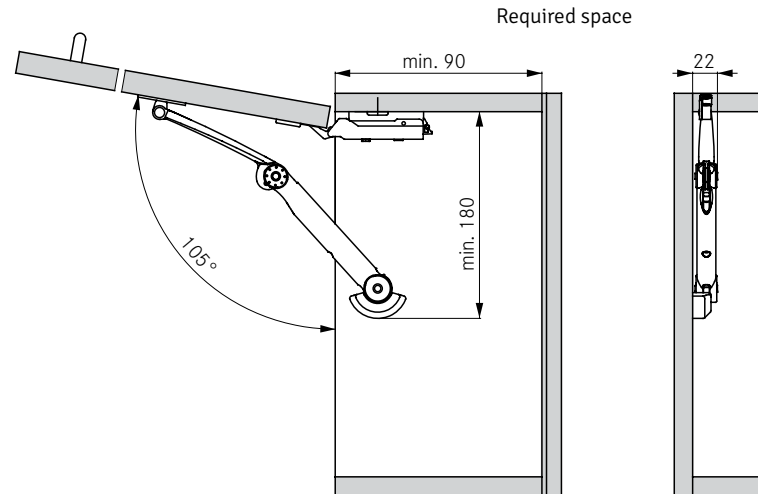

Front:
installation for flaps with standard aluminium frame profiles (19 mm)

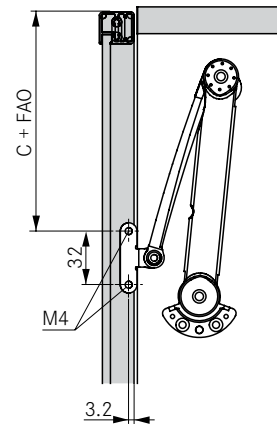

Front: installation for wooden and frame flaps
(min. 45 mm width)

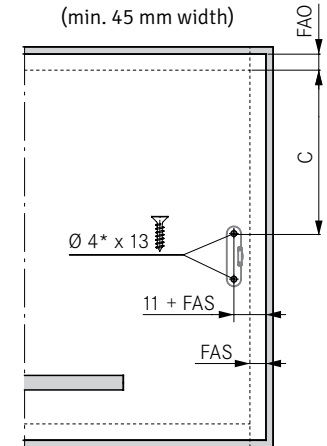

* Pre-drilling required - Ø 2 mm

OPENING ANGLE	A	B	C
95°	169 + MH	174 + MH	118 + MH
≥ 105°	164 + MH	169 + MH	113 + MH

The installation dimensions apply to hinges with 0 cranking and the respective mounting plate height.

The opening angle can vary between 95° and 105° (approx.), depending on type of hinge and application method.

Calculation of flap weight

Flap width x flap height x flap thickness x density ¹ + weight of handle ² = weight of flap

¹ Densities: MDF 0.85 kg/dm³, chipboard 0.65 kg/dm³, spruce/pine 0.45 kg/dm³

² For bar handles, allow 0.1 kg for each 100 mm handle width. We recommend a trial fitting

Minimum reveal and protrusion depend on the hinge used. For suitable hinges please refer to the Hinge Systems section.

Where cup hinges with different opening angles are used in a combination of wooden flaps and aluminium frame flaps, the smaller opening angle of the hinges used determines the installation dimensions for both flaps.

LEGEND					
A	Fixing dimension, side wall	B	Fixing dimension, side wall	C	Fixing dimension, front
FAO	Front overlay, top	FAS	Front overlay, side	MH	Mounting plate height

GRASS KINVARO FLAP SYSTEMS

KINVARO F-20 ADJUSTMENT OPTIONS

ADJUSTMENT OPTIONS FOR HINGE IN CABINET TOP PANEL



Height adjustment (HV)

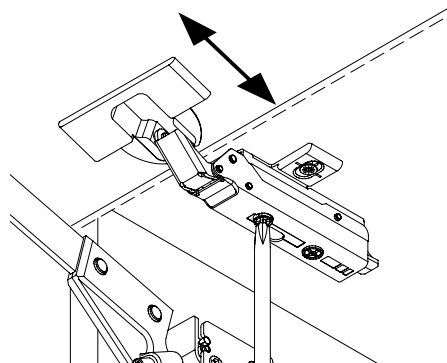

Side adjustment (SV)

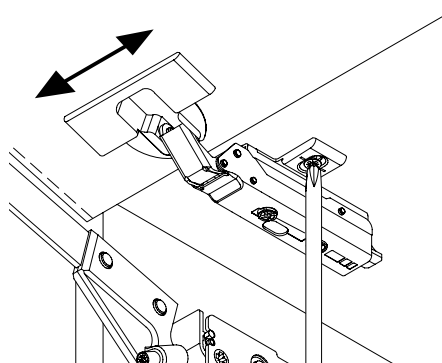

Depth adjustment (TV)

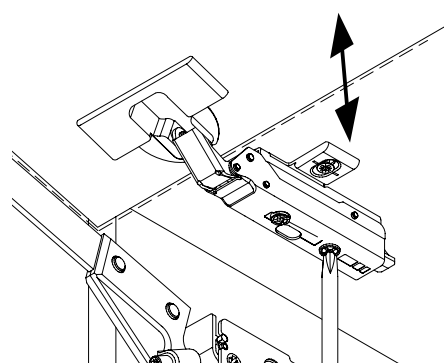

Height adjustment (HV)

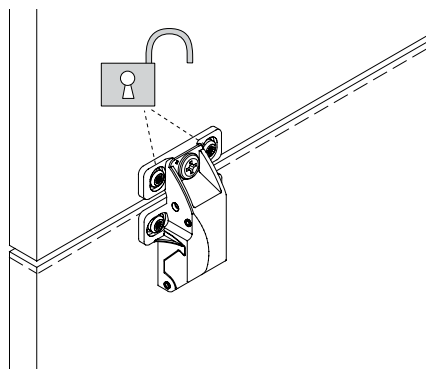

Adjustment options for intermediate hinge

+/- 1.5

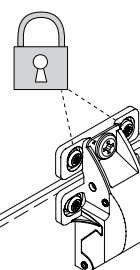
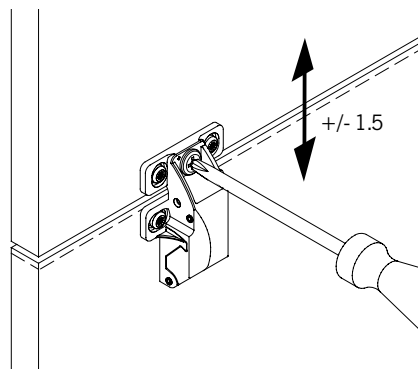

Side adjustment (SV)

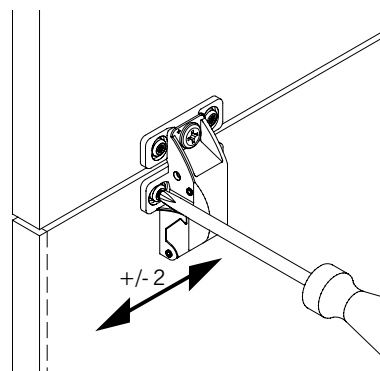

+/- 2

Depth adjustment (TV)

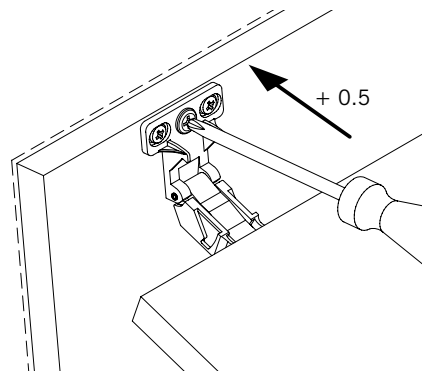

+ 0.5

G*GRASS®

WARNING

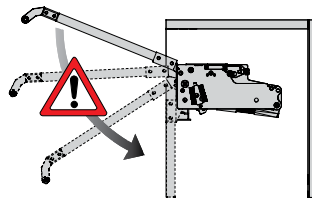

NOTE

Adjusting the flap closing position

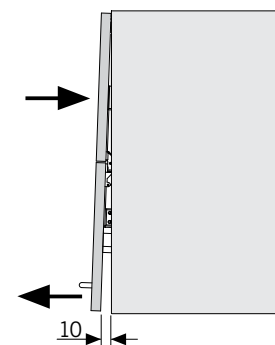
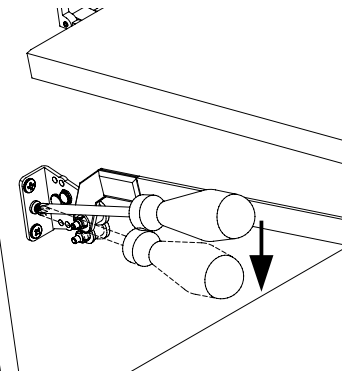
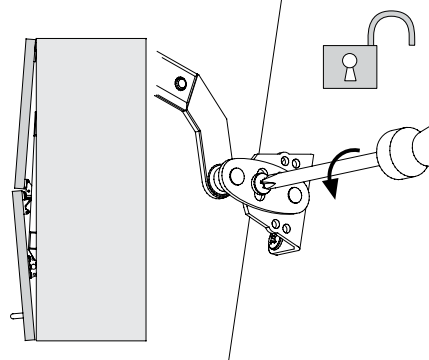

Adjusting the spring force

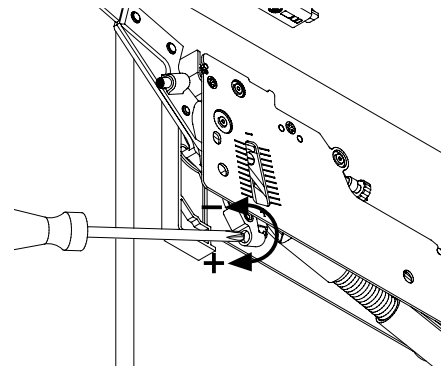
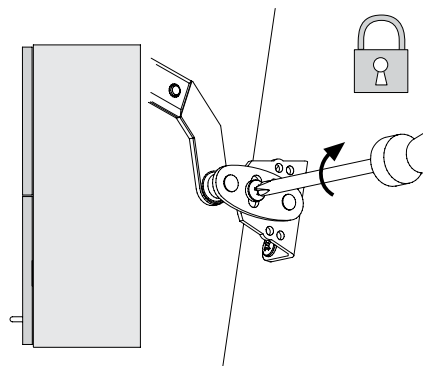

Adjusting the damping system

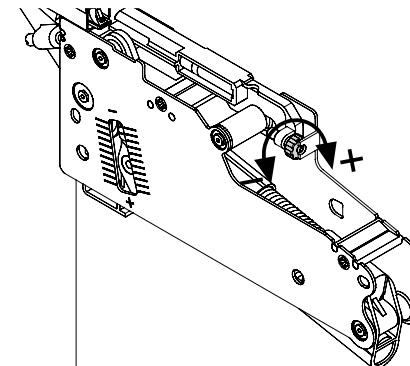

Adjusting the opening angle 90° to 120°

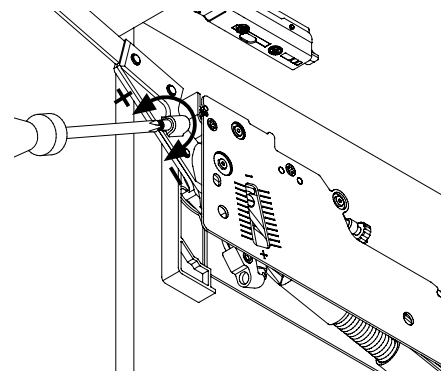
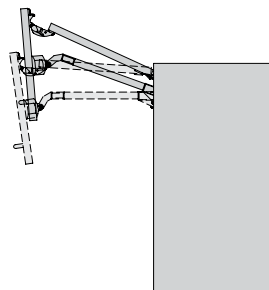

GRASS KINVARO FLAP SYSTEMS

KINVARO L-80 ADJUSTMENT OPTIONS

G*GRASS®

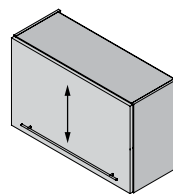
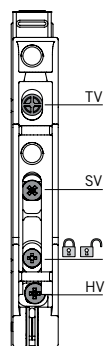

(HV) Height adjustment
+/- 1.5 mm

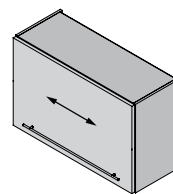

(SV) Side adjustment
+/- 1.5 mm

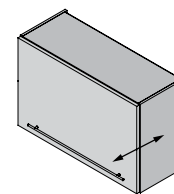

(TV) Depth adjustment
+/- 1.5 mm

All adjustments can be carried out independently of each other.

ADJUSTMENT OPTIONS

Unlocking

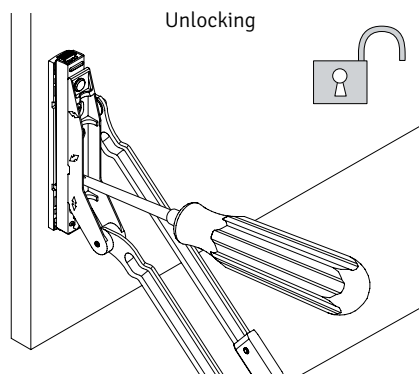

Height adjustment (HV)

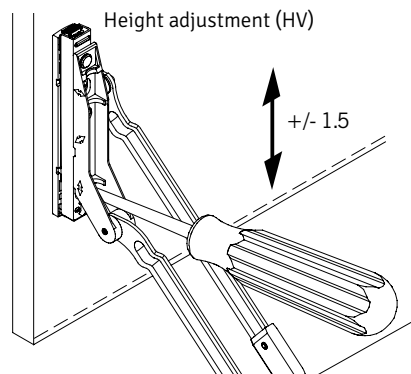

Side adjustment (SV)

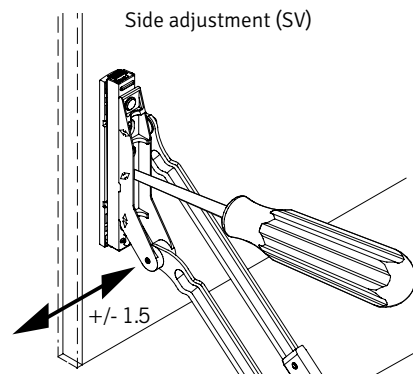

Depth adjustment (TV)

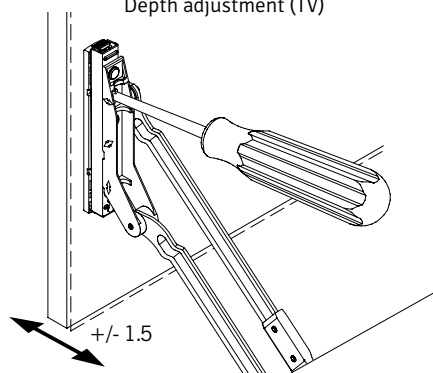

Adjustments
Locking

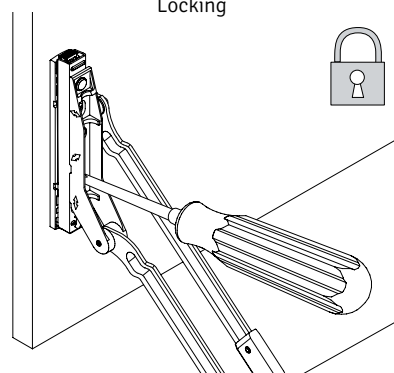

Adjusting the spring force

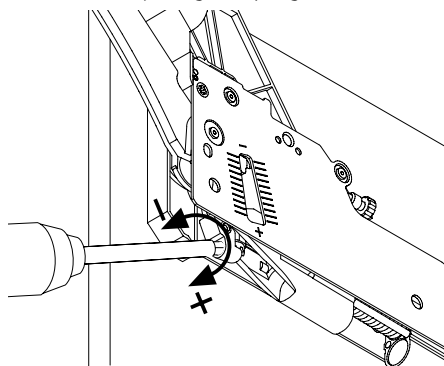

Adjusting the damping system

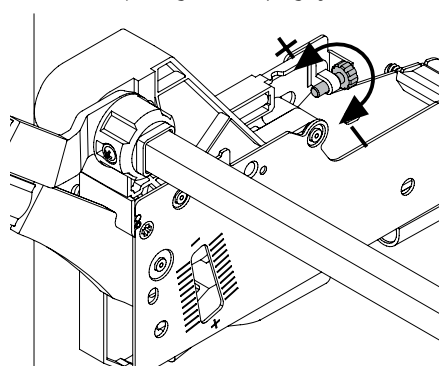

WARNING

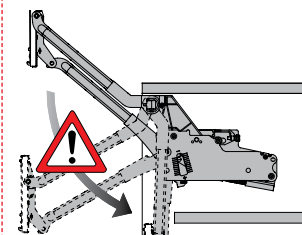

NOTE

G*GRASS®

KINVARO S-35 ADJUSTMENT OPTIONS

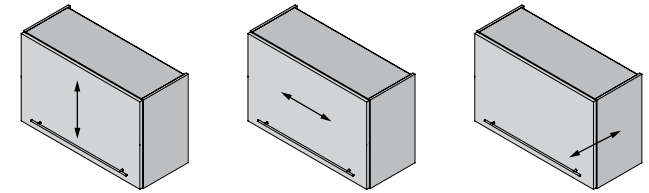

(HV) Height adjustment
+/- 1.5 mm

(SV) Side adjustment
+/- 1.5 mm

(TV) Depth adjustment
+/- 1.5 mm

All adjustments can be carried out independently of each other.

WARNING

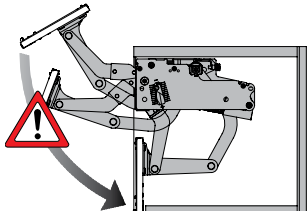

NOTE

ADJUSTMENT OPTIONS

Side adjustment (SV)

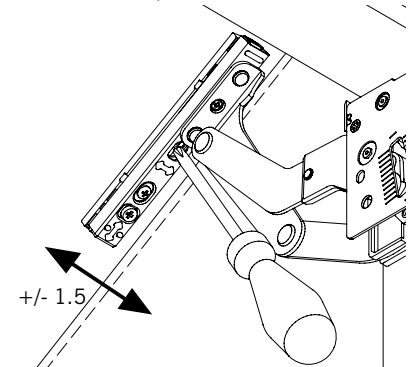

Height adjustment (HV)

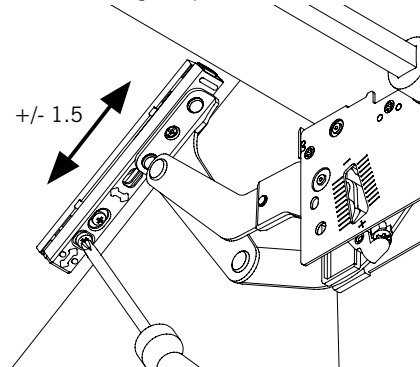

Unlocking

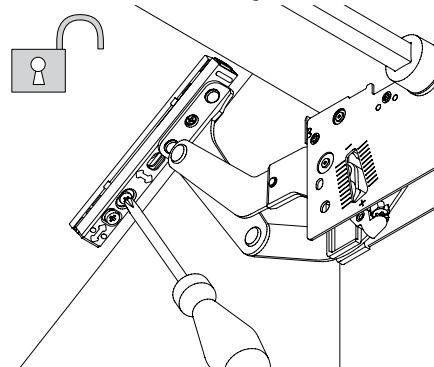

Depth adjustment (TV)

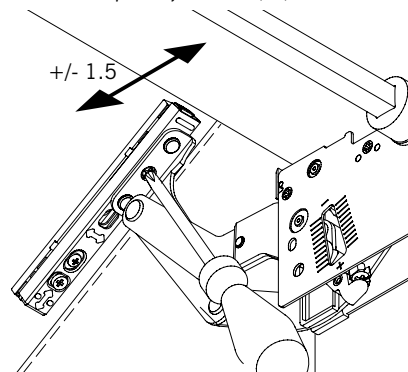

Locking

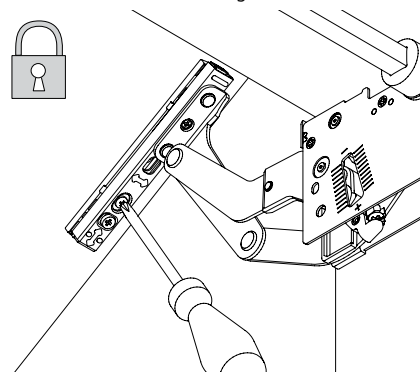

ADJUSTMENTS

Adjusting the spring force

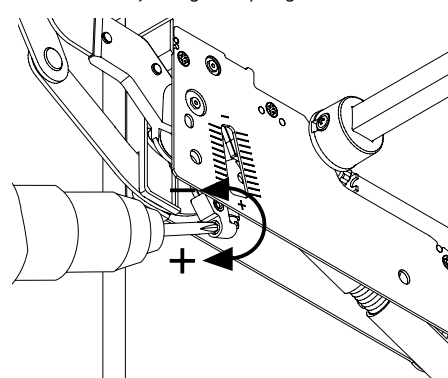

Adjusting the damping system

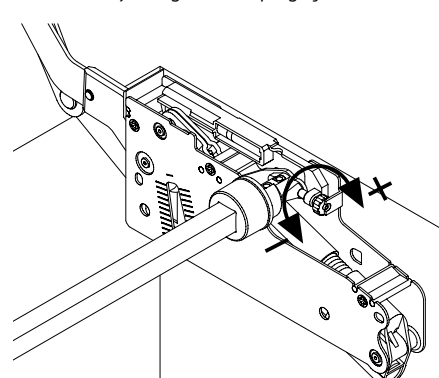

GRASS KINVARO FLAP SYSTEMS

KINVARO T-71 ADJUSTMENT OPTIONS

G*GRASS®

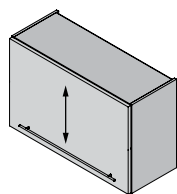
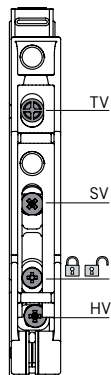

(HV) Height adjustment
+/- 1.5 mm

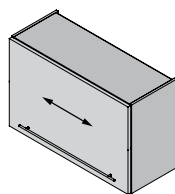

(SV) Side adjustment
+/- 1.5 mm

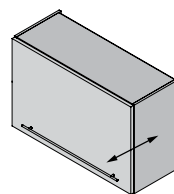

(TV) Depth adjustment
+/- 1.5 mm

All adjustments can be carried out independently of each other.

ADJUSTMENT OPTIONS

Unlocking

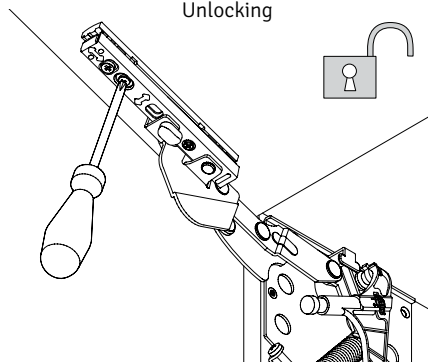

Height adjustment (HV)

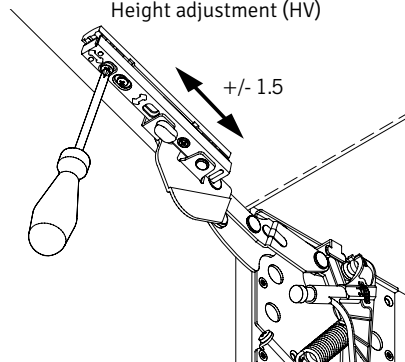

Side adjustment (SV)

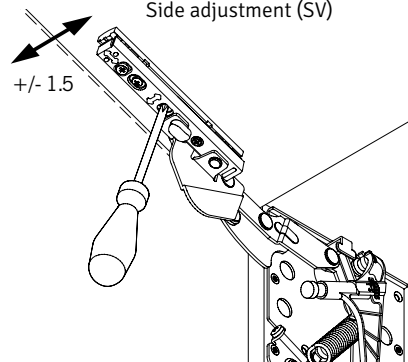

Depth adjustment (TV)

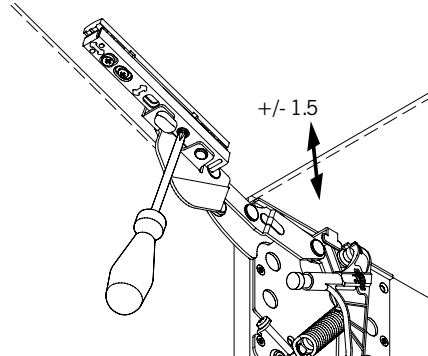

Locking

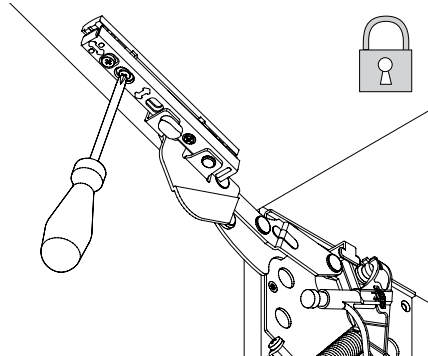

ADJUSTMENTS

Adjusting the spring force

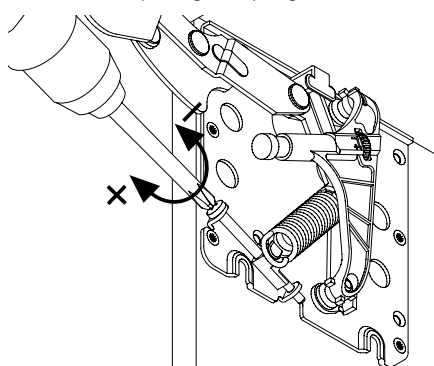

Adjusting the damping system

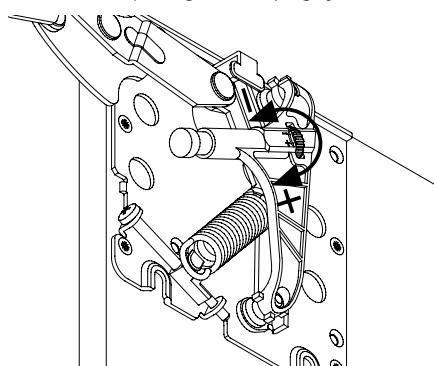

WARNING

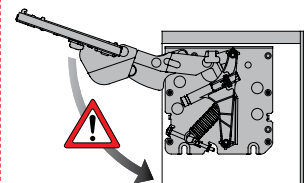

NOTE



KINVARO T-76 ADJUSTMENT OPTIONS

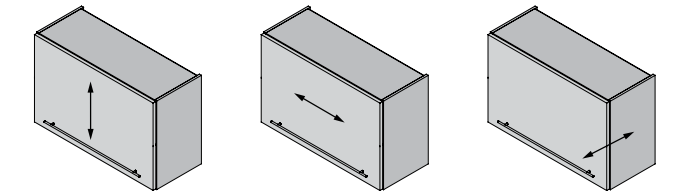

(HV) Height adjustment
+/- 1.5 mm

(SV) Side adjustment
+/- 1.5 mm

(TV) Depth adjustment
+/- 1.5 mm

All adjustments can be carried out independently of each other.

WARNING

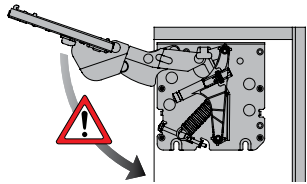

NOTE

Unlocking

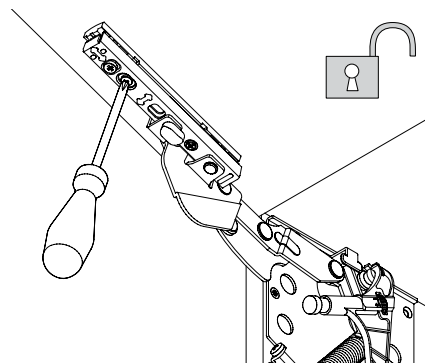

Height adjustment (HV)

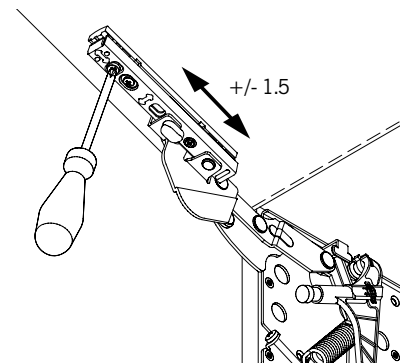

ADJUSTMENT OPTIONS

Side adjustment (SV)

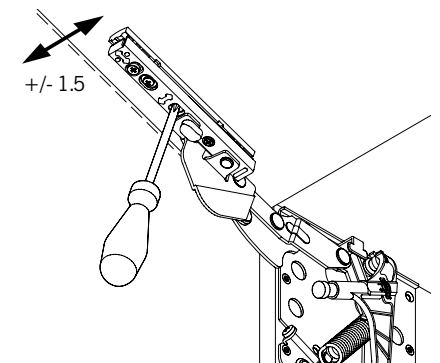

Depth adjustment (TV)

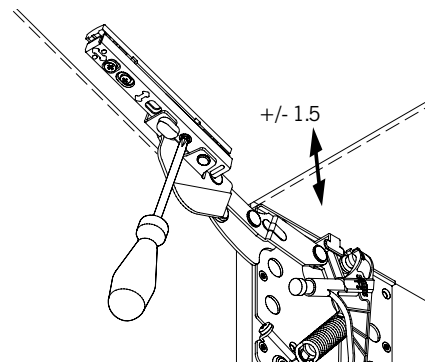

Locking

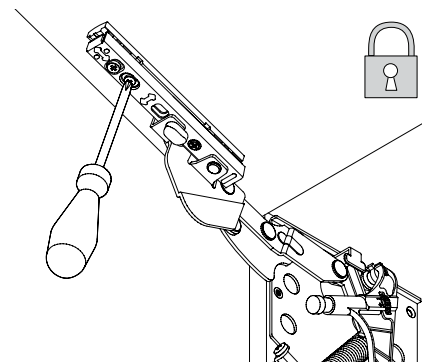

ADJUSTMENTS

Adjusting the spring force

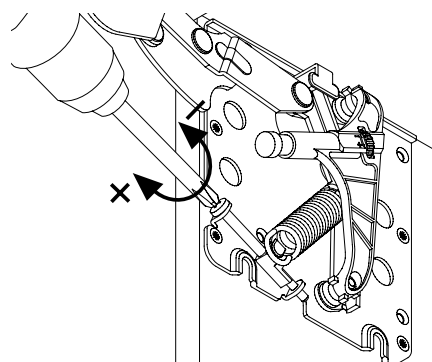

Adjusting the damping system

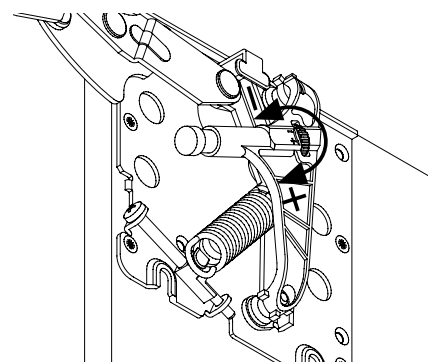

GRASS KINVARO FLAP SYSTEMS

KINVARO T-57 ADJUSTMENT OPTIONS

G*GRASS®

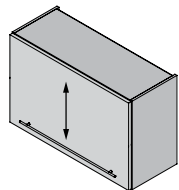

(HV) Height adjustment
+/- 1 mm

All adjustments can be carried out independently of each other.

ADJUSTMENT OPTIONS

Height adjustment (HV)

Locking

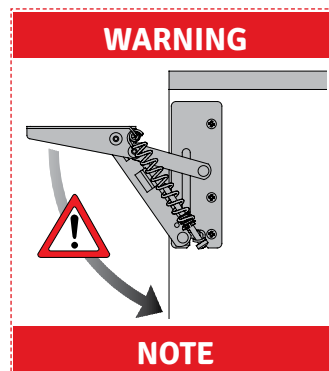
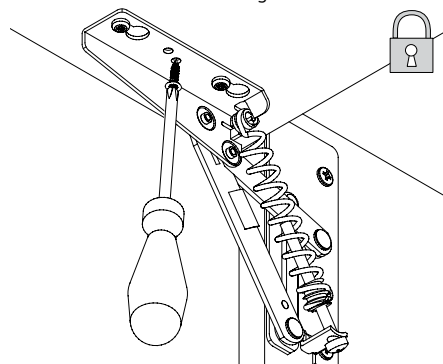
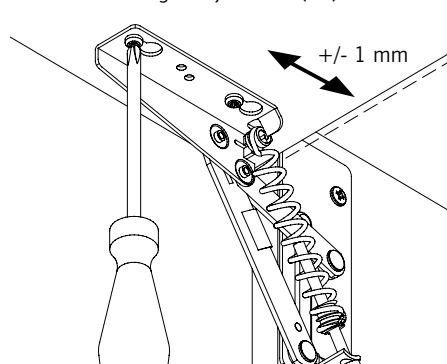

ADJUSTMENTS

Adjusting to 75° opening angle

Adjusting to 100° opening angle

Adjusting the spring force

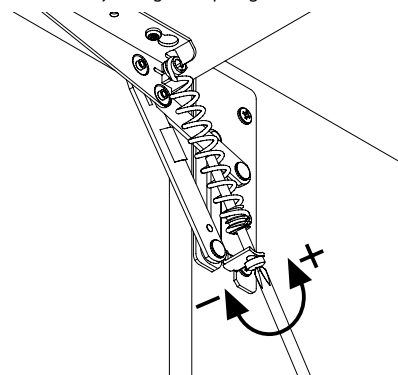
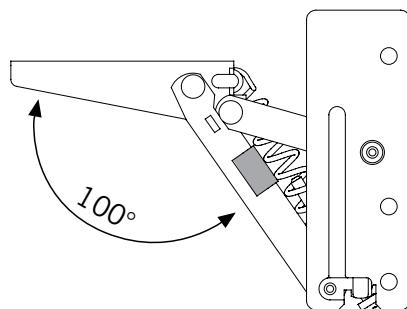
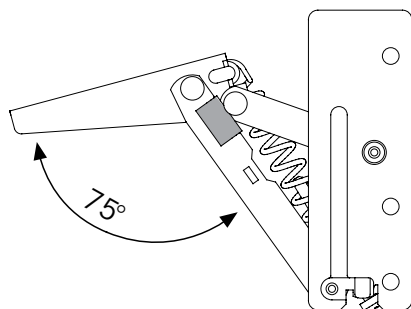



KINVARO T-105 ADJUSTMENT OPTIONS

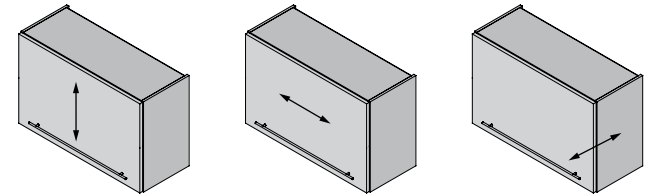

(HV) Height adjustment (SV) Side adjustment (TV) Depth adjustment

All adjustments can be carried out independently of each other.

ADJUSTMENT OPTIONS FOR HINGE IN CABINET TOP PANEL

Height adjustment (HV)

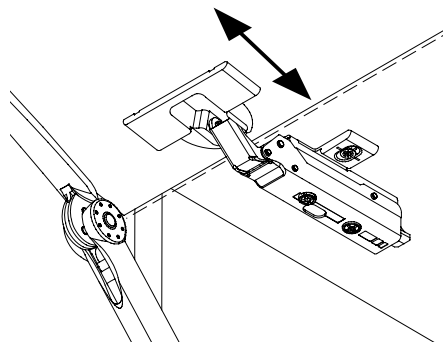

Side adjustment (SV)

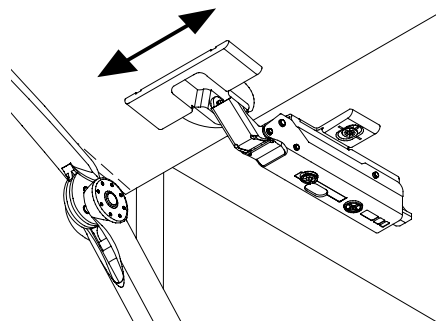

Depth adjustment (TV)

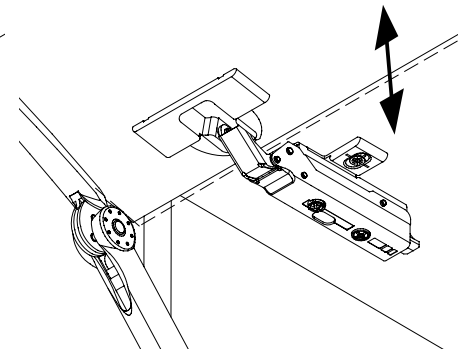

ADJUSTMENTS

Adjusting the spring force

